

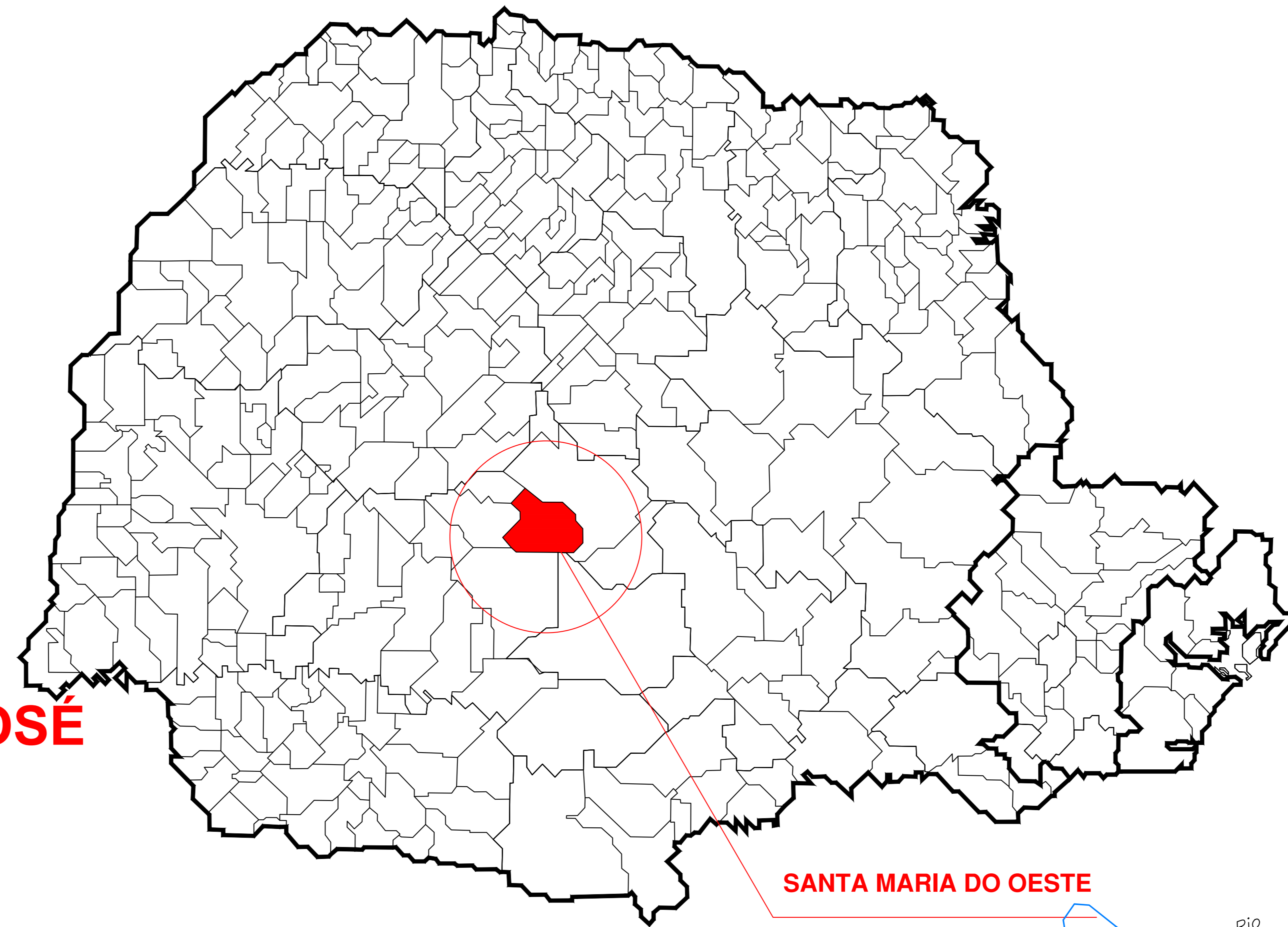

PERÍMETRO URBANO DISTRITO SÃO JOSÉ



SANTA MARIA DO OESTE

-  Lotes com edificações
-  Lotes Vagos
-  Ruas a Pavimentar - RECAPE

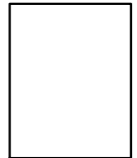
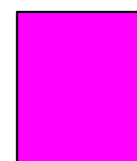
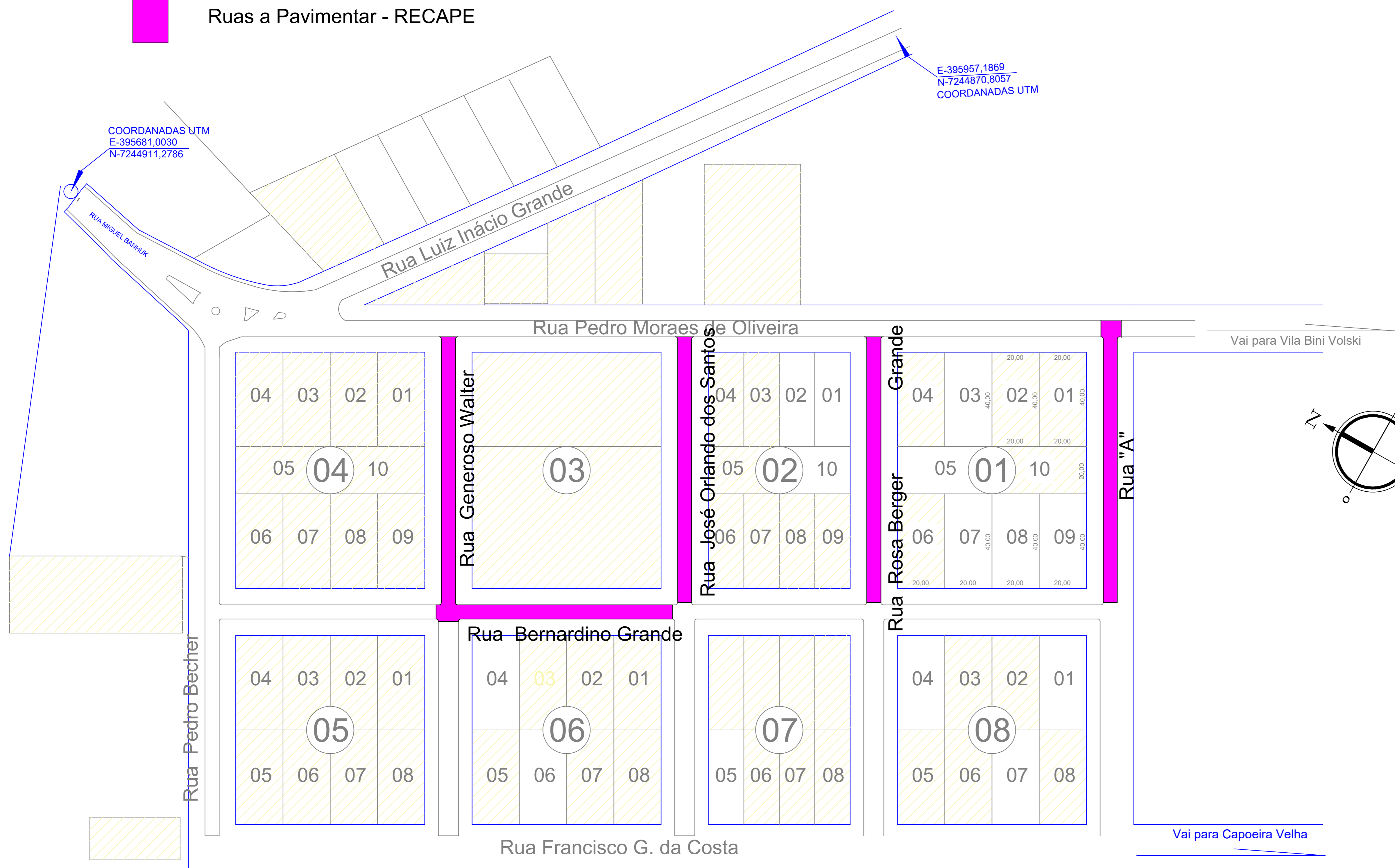
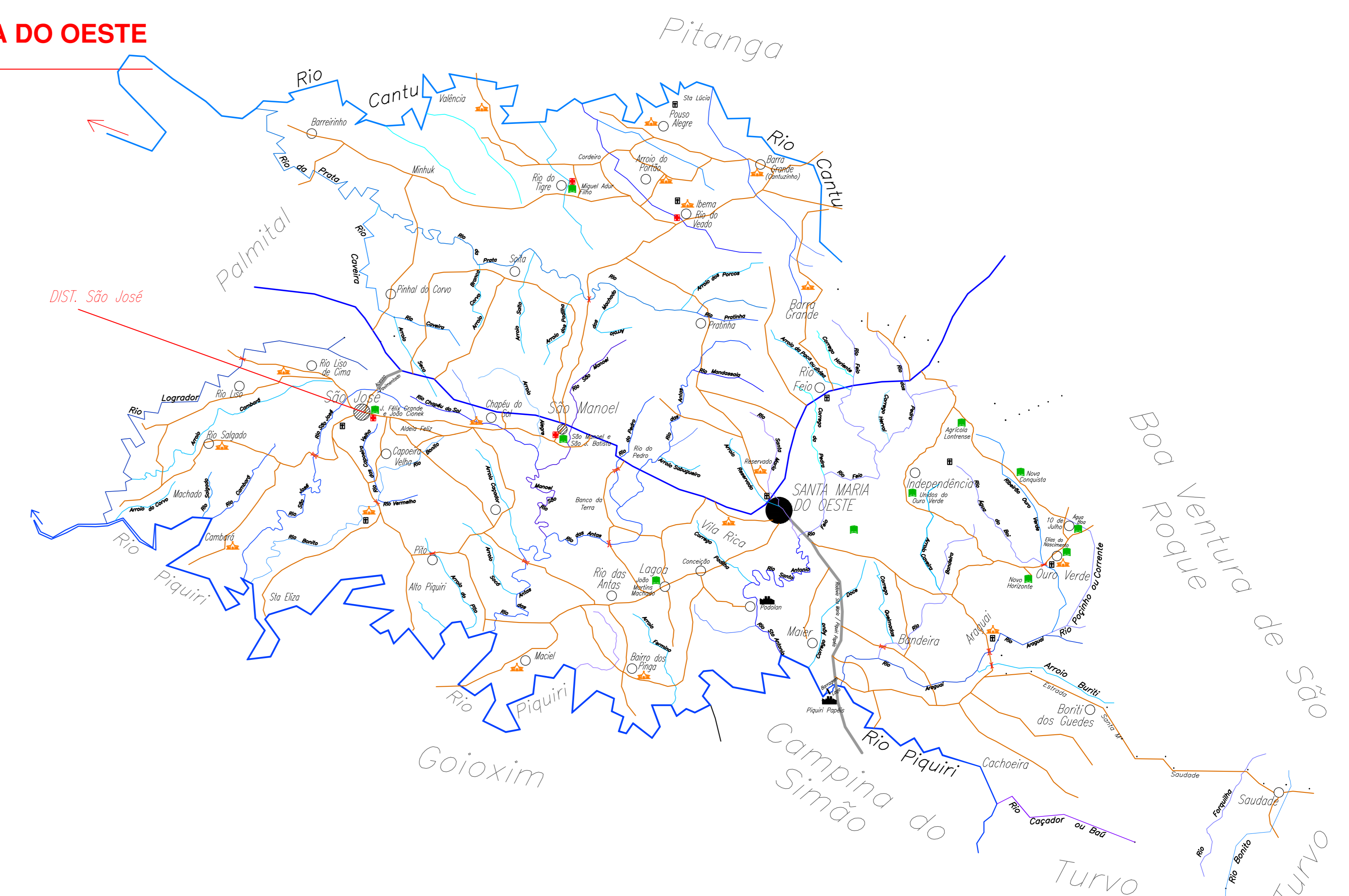

PREFEITURA MUNICIPAL DE SANTA MARIA DO OESTE																
CNPJ: 95.684.544/0001-26																
<small>Rua José de França Pereira, nº 10 - Fone: (41) 3644-1137 CEP: 82301-000 - Santa Maria do Oeste - Paraná</small>																
RECAPE ASFÁLTICO EM CBUQ																
<small>RUAS DO DISTRITO DE SÃO JOSÉ - SANTA MARIA DO OESTE-PR</small>																
PROJETO DE ARQUITETÔNICO																
APROVAÇÕES	DESENHO	DATA														
	JAIMÉ	02/05/2023														
		ULTIMA REVISÃO														
		29/05/2023														
RECAPE ASFÁLTICO																
<table border="0"> <tr> <td>Rua Generoso Walter :</td> <td>634,07 m²</td> </tr> <tr> <td>Rua José dos Santos P. :</td> <td>634,07 m²</td> </tr> <tr> <td>Rua Rosa B. Grande :</td> <td>634,07 m²</td> </tr> <tr> <td>Rua Projetada "A" :</td> <td>749,42 m²</td> </tr> <tr> <td>Rua Bernardino Grande :</td> <td>692,40 m²</td> </tr> <tr> <td>Rua Bernardino Grande(base) :</td> <td>248,63 m²</td> </tr> <tr> <td>Total:</td> <td>3.593,66 m²</td> </tr> </table>			Rua Generoso Walter :	634,07 m ²	Rua José dos Santos P. :	634,07 m ²	Rua Rosa B. Grande :	634,07 m ²	Rua Projetada "A" :	749,42 m ²	Rua Bernardino Grande :	692,40 m ²	Rua Bernardino Grande(base) :	248,63 m ²	Total:	3.593,66 m²
Rua Generoso Walter :	634,07 m ²															
Rua José dos Santos P. :	634,07 m ²															
Rua Rosa B. Grande :	634,07 m ²															
Rua Projetada "A" :	749,42 m ²															
Rua Bernardino Grande :	692,40 m ²															
Rua Bernardino Grande(base) :	248,63 m ²															
Total:	3.593,66 m²															
RESPONSÁVEL TÉCNICO	PROJECIONISTA	ESCALA														
Jaime Luiz de Oliveira CREA-PR 29087/D	OSCAR DELGADO PREFEITO MUNICIPAL	Indicadas														
		FRANZISA														
		01/03														